

The Corn Exchange, Melrose

Total Floor Area = 163m²

Floor Area Less 1m Walkways = 153m²

Maximum Theoretical Standing Capacity = 590

Effective Door Widths Make Actual Maximum Occupancy = 377

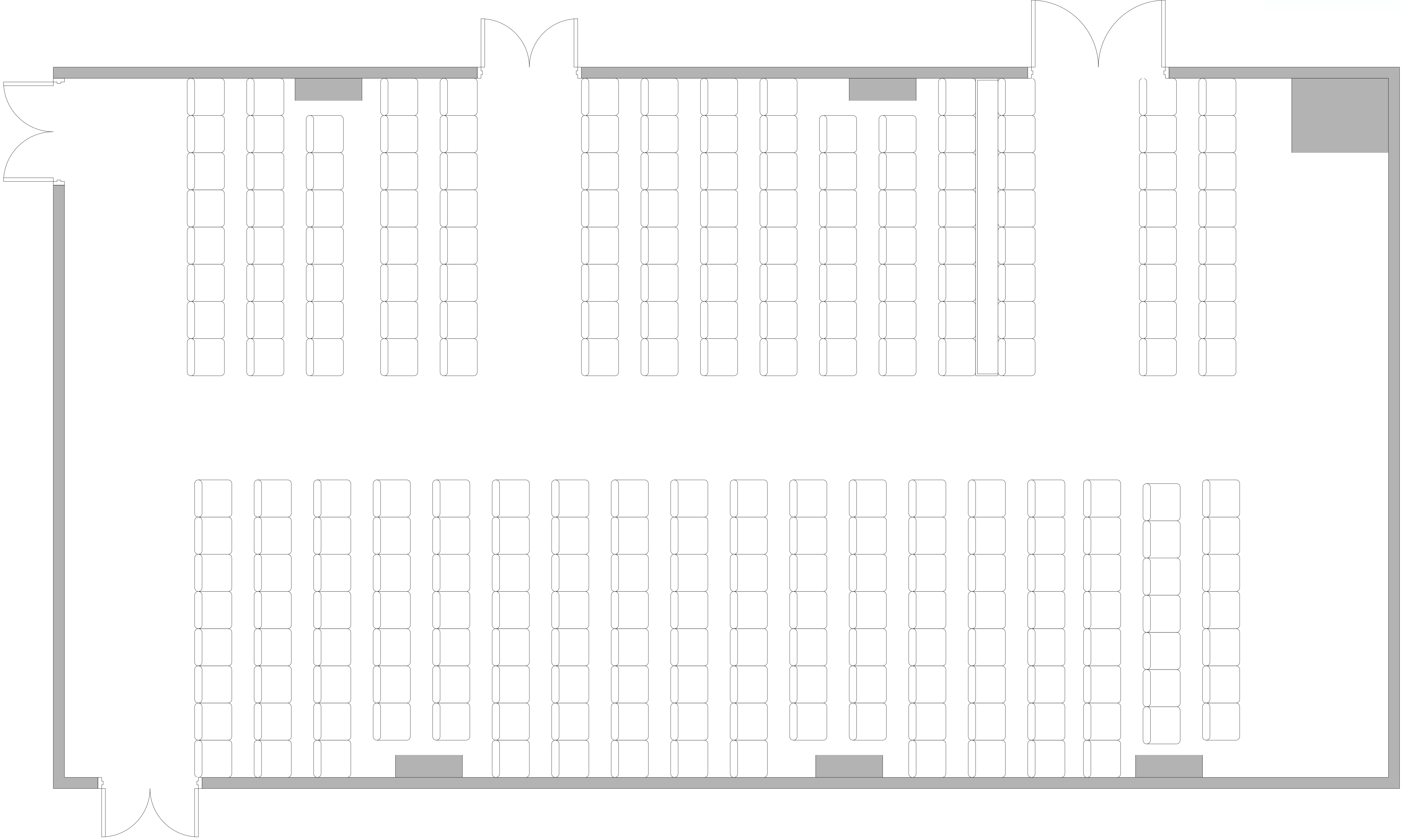

The Corn Exchange, Melrose

Standing Only

Maximum Standing Capacity = 377

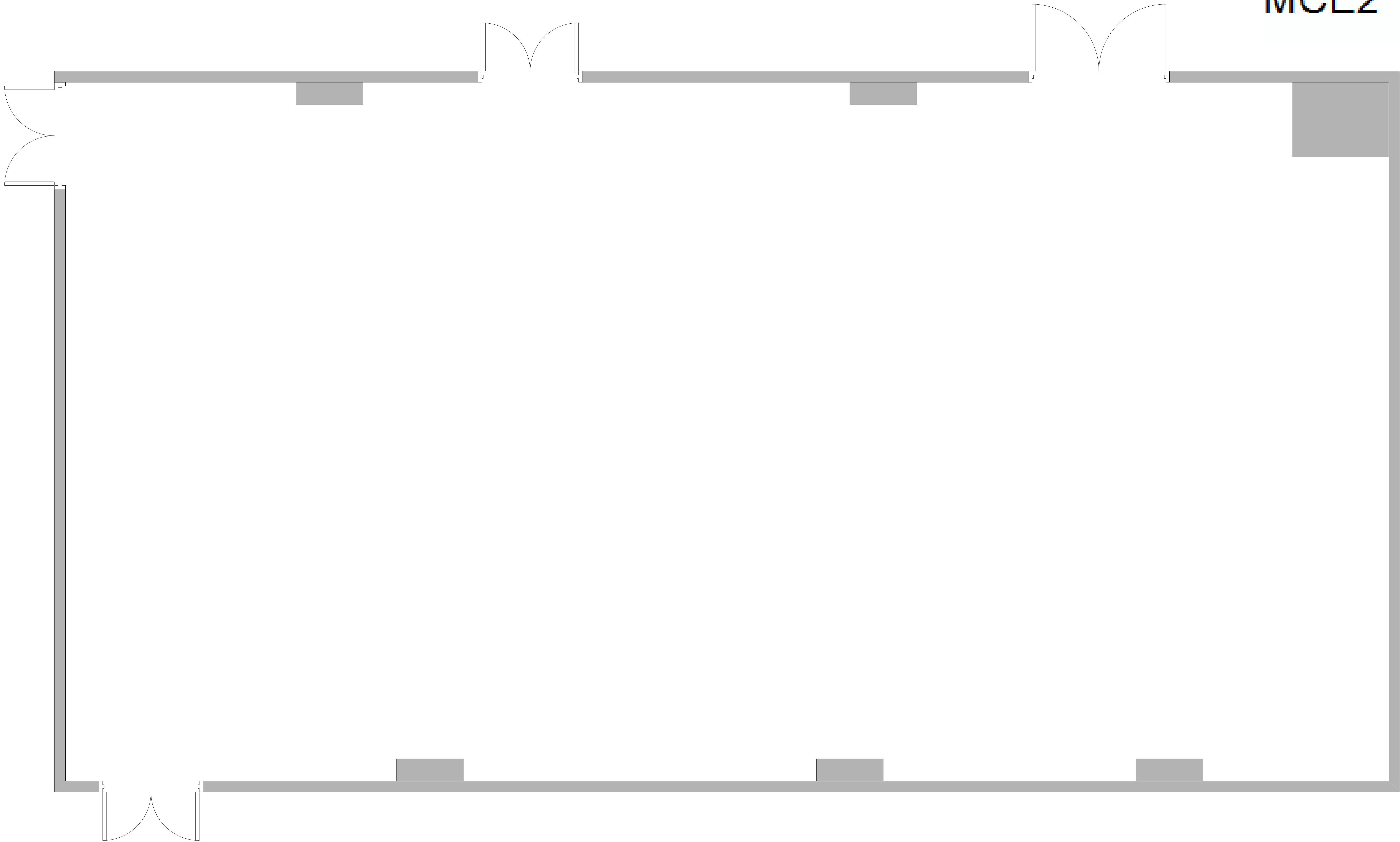

The Corn Exchange, Melrose Full Seating



Maximum Seated Capacity = 255

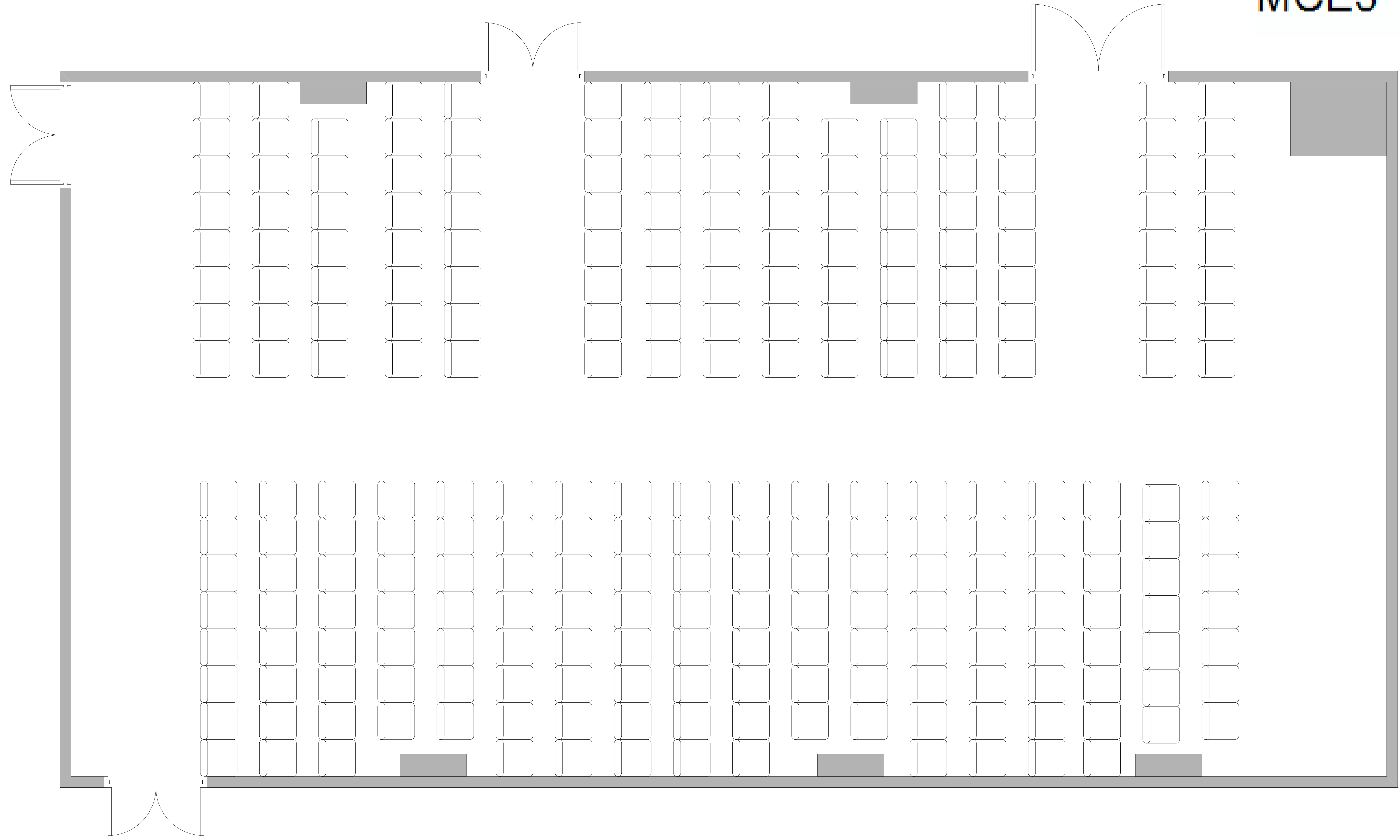

Layout and capacity based on the requirements of BS 9999: 2008 - Code of practice for fire safety in the design, management and use of buildings

The Corn Exchange, Melrose Cabaret Layout



Maximum Cabaret Capacity = 102

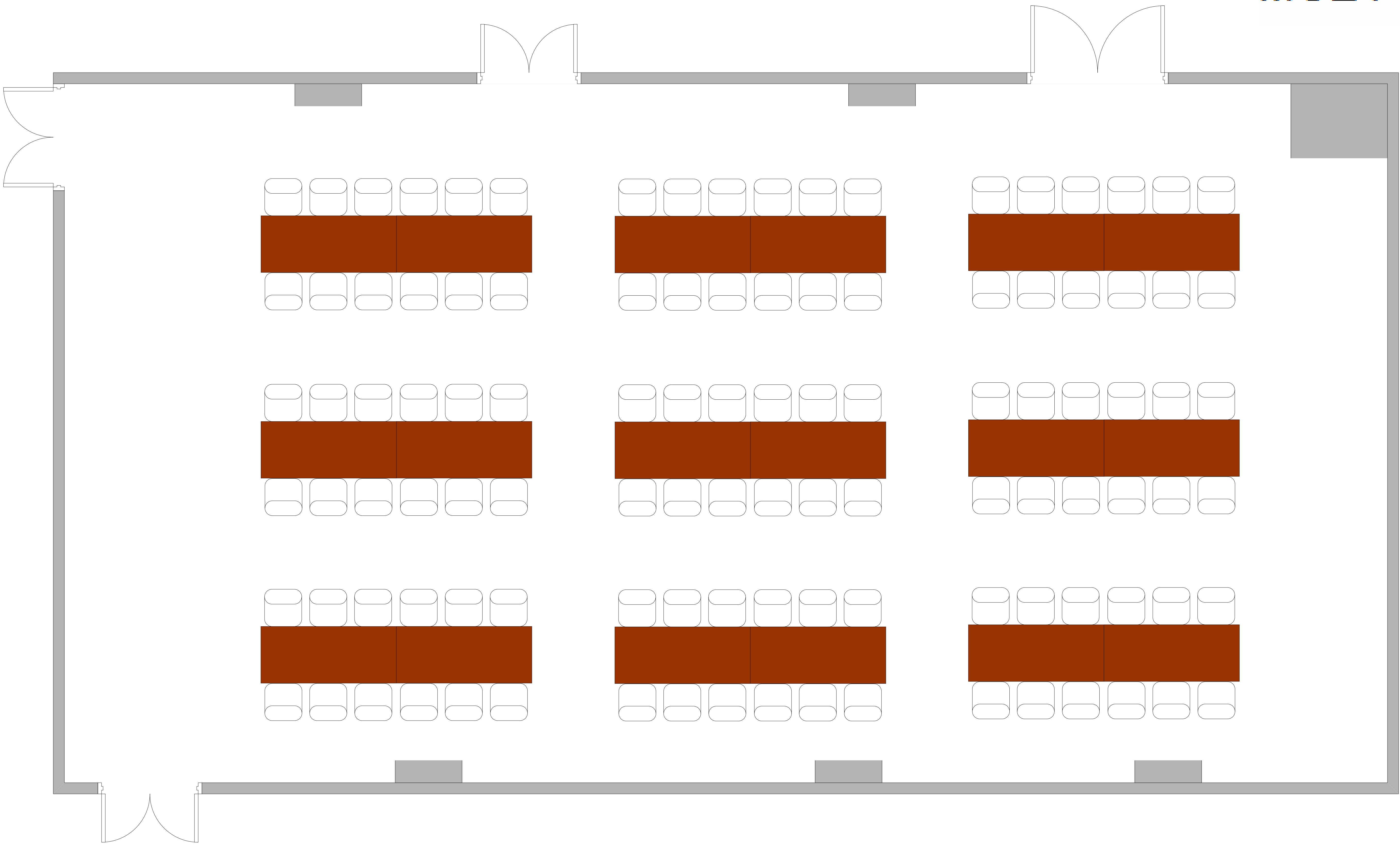

Layout and capacity based on the requirements of BS 9999: 2008 - Code of practice for fire safety in the design, management and use of buildings

The Corn Exchange, Melrose

Dinner Layout



Maximum Dinner Capacity = 96

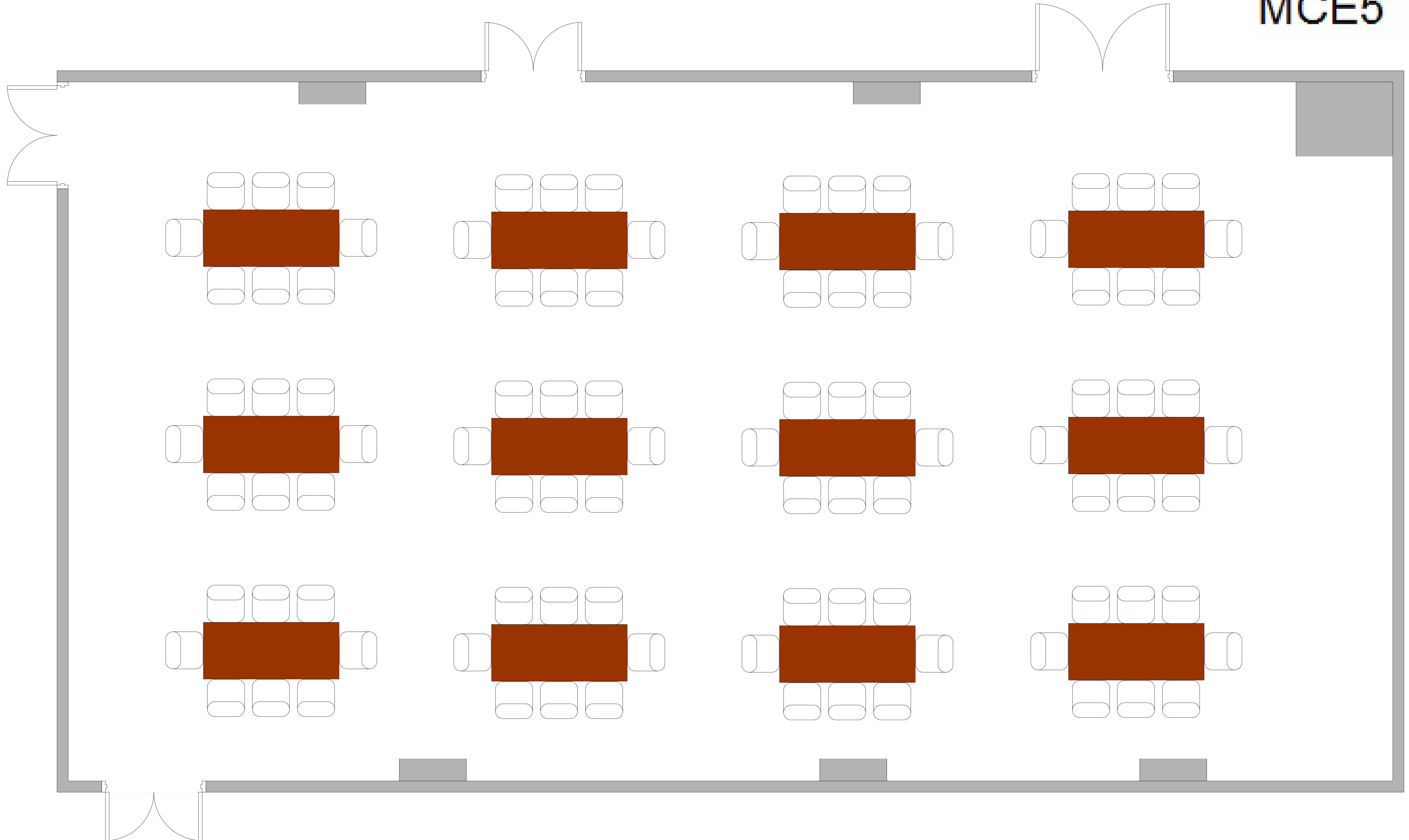

Layout and capacity based on the requirements of BS 9999: 2008 - Code of practice for fire safety in the design, management and use of buildings

The Corn Exchange, Melrose Dinner Dance – Disco Layout

Maximum Dinner Dance Capacity = 87

This layout is for Disco style Dancing. Ballroom style dancing or a Ceilidh will have reduced capacity.

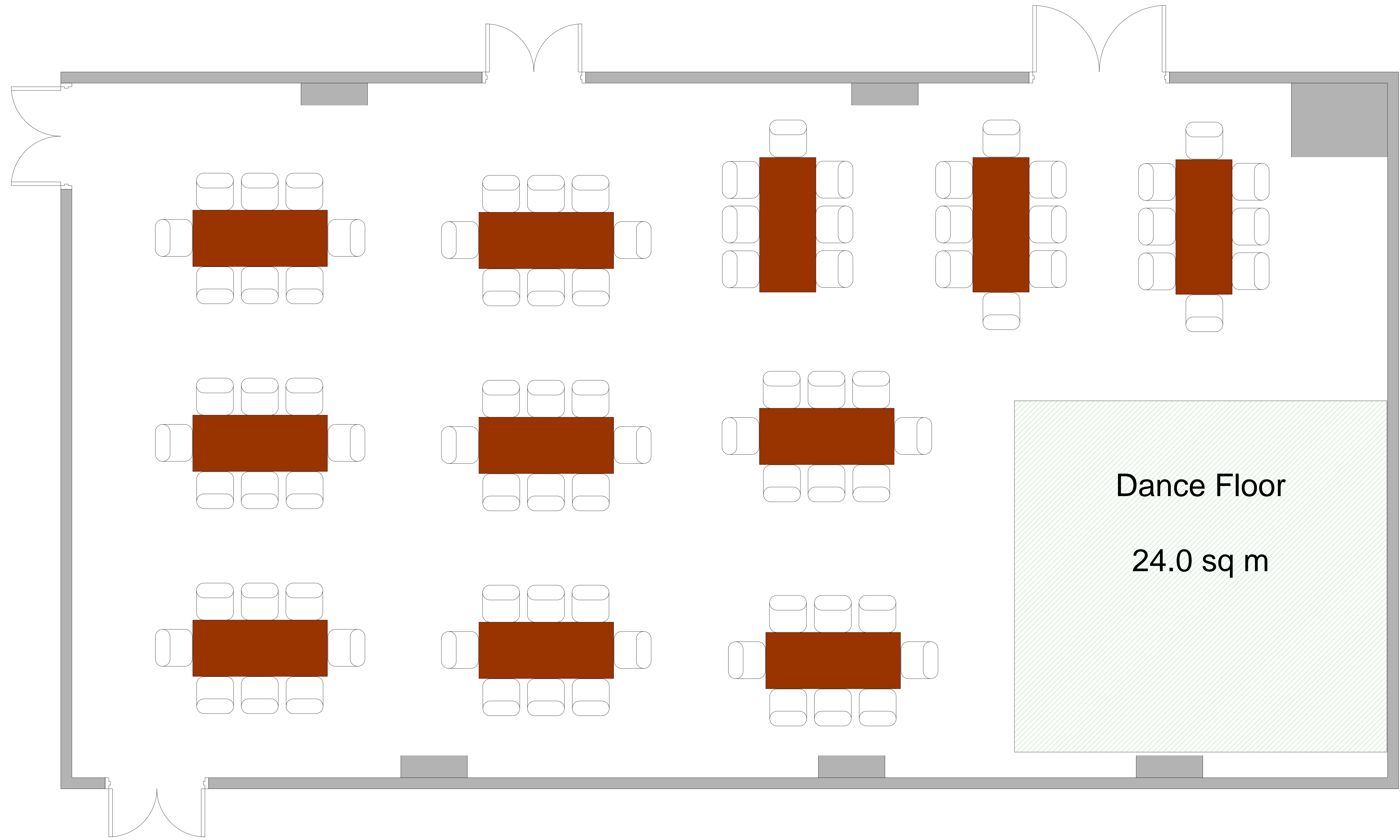

The Corn Exchange, Melrose Dinner Dance – Ceilidh Layout



Maximum Ceilidh Capacity = 102

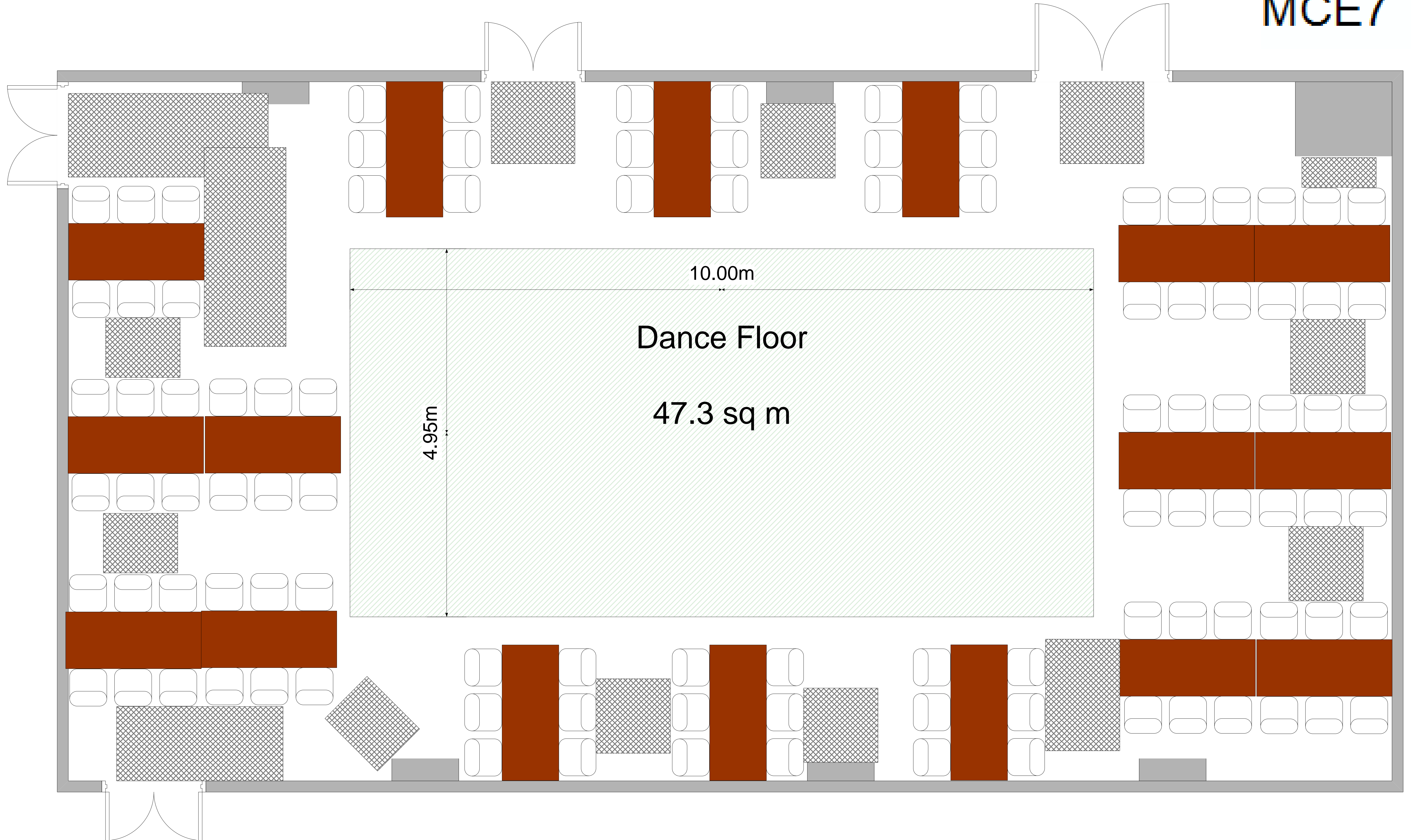

Layout and capacity based on the requirements of BS 9999: 2008 - Code of practice for fire safety in the design, management and use of buildings

The Corn Exchange, Melrose Table Top Sale



Maximum Capacity = 240 people based on 25 tables

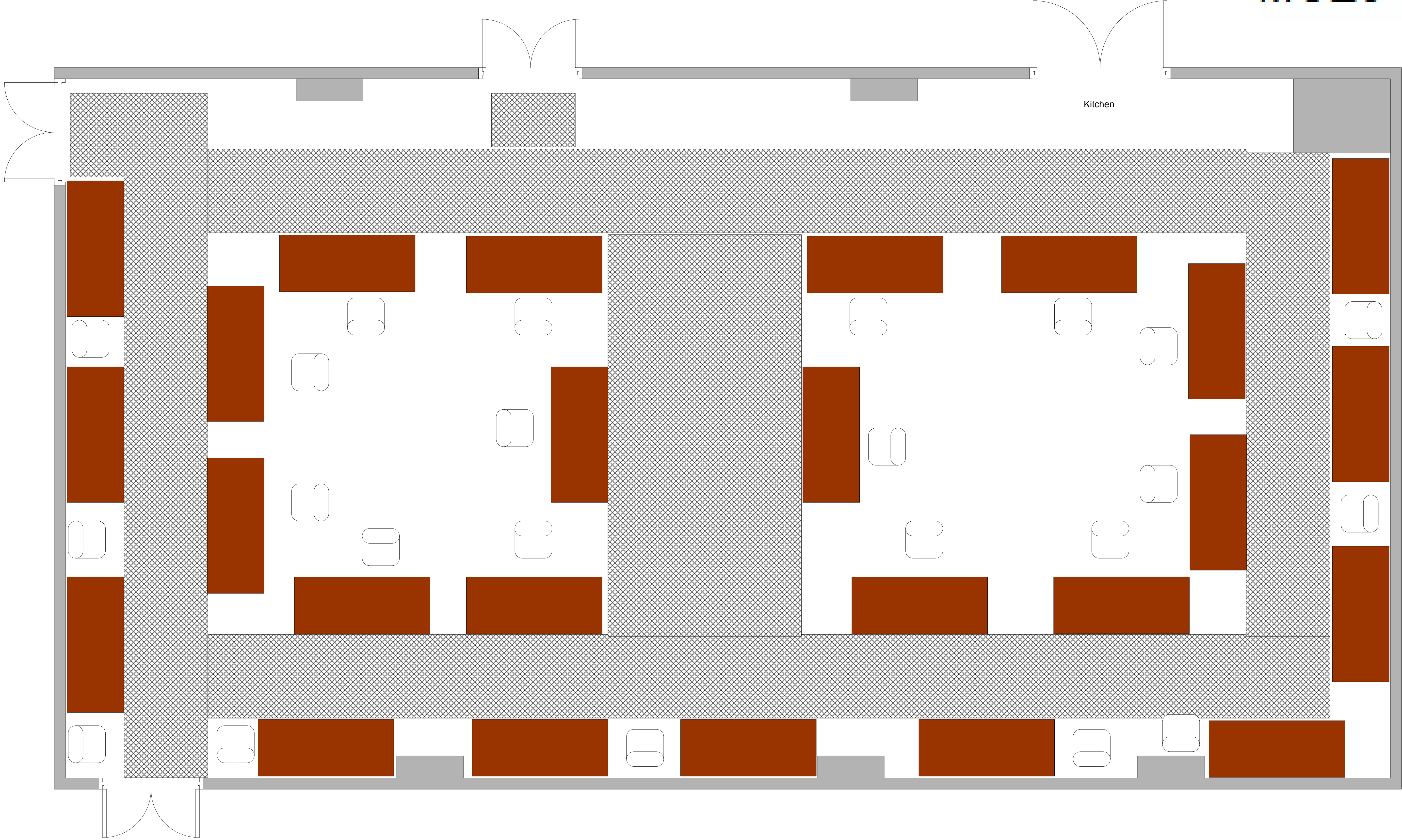

Layout and capacity based on the requirements of BS 9999: 2008 - Code of practice for fire safety in the design, management and use of buildings